

IAED 2012 - 2013
SPRING SEMESTER

İZMİR UNIVERSITY OF ECONOMICS
FACULTY OF FINE ARTS AND DESIGN

DEPARTMENT OF INTERIOR ARCHITECTURE AND ENVIRONMENTAL DESIGN

WELCOMES YOU TO IAED 202 DESIGN STUDIO FINAL JURY

“HEALTHY LIVING IN ASMA BAHÇELER”

Instructors:

Asst. Prof. Dr. Deniz HASIRCI - Sedef MENTEŞE AKAD

Didem ÖZDEL - Rana VANLI - İpek KAŞTAŞ



İZMİR EKONOMİ ÜNİVERSİTESİ

Onuncu yıl



INTERIOR DESIGN OF A RESIDENCE

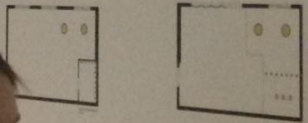

My user profile is middle aged. Their hobbies are related to nature. They like nature. So my inspiration source is nature. I want to use peace of nature at the same time discuss asymmetry of nature.

IAED 202 HEALTHY LIVING IN ASMA BAHÇELER SCENERIO

Healthy Home must be analysed in terms of psychological mostly. Everyone wants to feel good, happy and peaceful at own home. If the home makes feel all of these, it is a healthy home. Therefore, while a home design, user profile is important.



3.06.13

IAED 202 HEALTHY LIVING IN ASMABAHCELER

An elderly couple who live in Asma Bahçeler. The old man used to work as a newspaper editor, and he was going to the newspaper to see his children every day. He used to go to the newspaper to see his children every day. He used to go to the newspaper to see his children every day.

INTEGRATED
RESPECT FOR NATURE
NATURAL MATERIALS
NATURAL LIGHTING
MEETS THE NEEDS



INTERIOR DESIGN OF A RESIDENCE





IAED 202 - HEALTHY LIVING IN ASMA BAHCELER



RESPECT
RELATIONS
EXERCISE
ENERGY

PARENT-CHILD

There is a young mother, she is a psychologist and she is interested with far eastern philosophies. And she brought into the life style.

There is a teenager as son, he is a student of performing arts. And he is also interesting with dance.

I need to create a peaceful space for this family. They have own priorities and they have own interests, they respect and support each others.



NEVIN SEVINC DEVECİ - 20100404017 / 03.06.2013

INTERIOR DESIGN OF RESIDENCE

