

2.Sınıf Final Jürisi











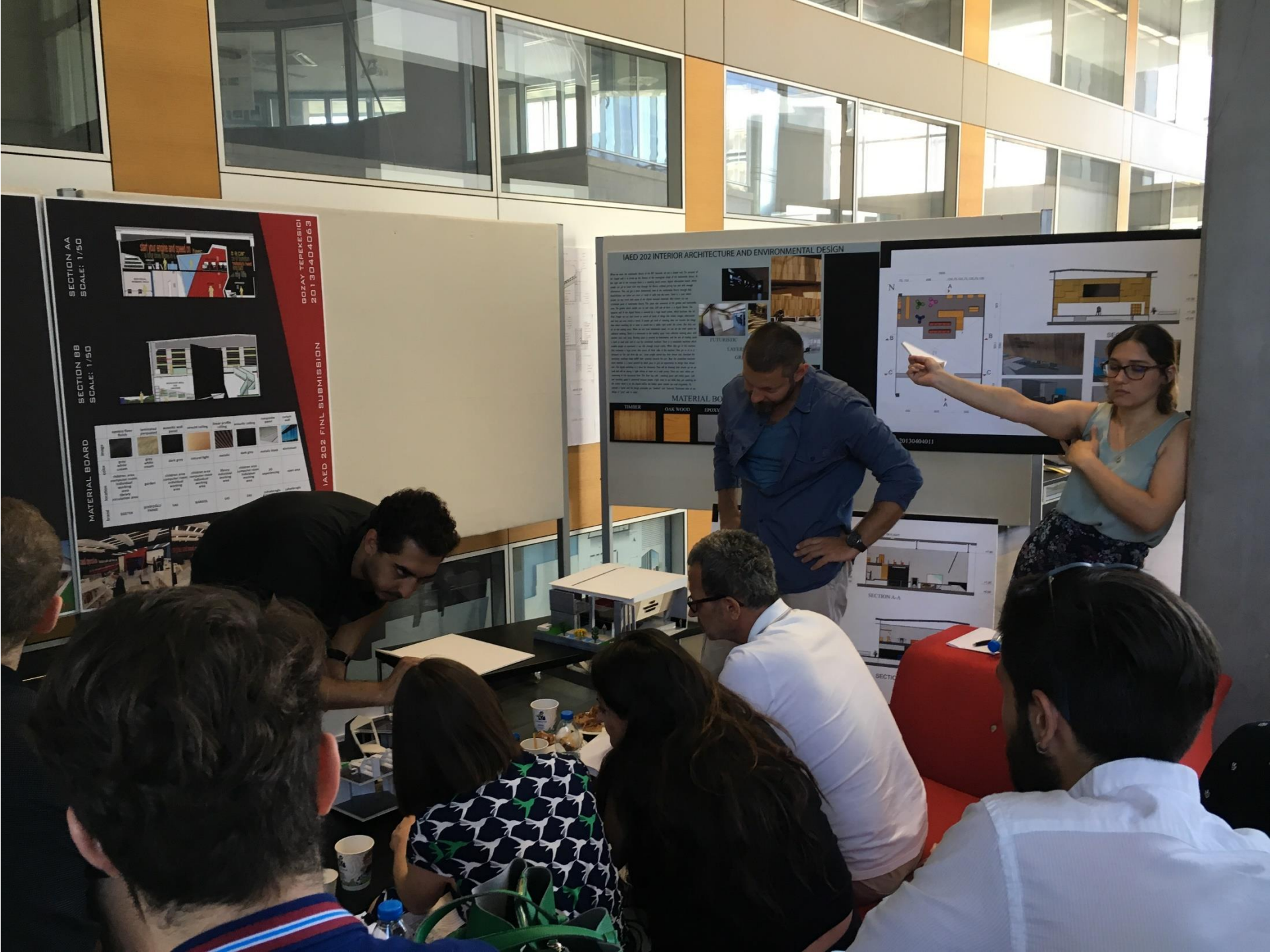

SECTION AA
SCALE: 1/50

SECTION BB
SCALE: 1/50

MATERIAL BOARD

IAED 202 FINAL SUBMISSION
20130404063

Material	Color	Texture
Dark Grey	Dark Grey	Smooth
Light Grey	Light Grey	Smooth
White	White	Smooth
Black	Black	Smooth
Dark Wood	Dark Wood	Wood Grain
Light Wood	Light Wood	Wood Grain
Dark Green	Dark Green	Smooth
Light Green	Light Green	Smooth
Dark Blue	Dark Blue	Smooth
Light Blue	Light Blue	Smooth
Dark Red	Dark Red	Smooth
Light Red	Light Red	Smooth
Dark Yellow	Dark Yellow	Smooth
Light Yellow	Light Yellow	Smooth
Dark Purple	Dark Purple	Smooth
Light Purple	Light Purple	Smooth

IAED 202 INTERIOR ARCHITECTURE AND ENVIRONMENTAL DESIGN

20130404011

SECTION A-A

SECTION B-B

MATERIAL BOARD

Material	Color	Texture
Dark Wood	Dark Wood	Wood Grain
Light Wood	Light Wood	Wood Grain
Dark Grey	Dark Grey	Smooth
Light Grey	Light Grey	Smooth
White	White	Smooth
Black	Black	Smooth
Dark Green	Dark Green	Smooth
Light Green	Light Green	Smooth
Dark Blue	Dark Blue	Smooth
Light Blue	Light Blue	Smooth
Dark Red	Dark Red	Smooth
Light Red	Light Red	Smooth
Dark Yellow	Dark Yellow	Smooth
Light Yellow	Light Yellow	Smooth
Dark Purple	Dark Purple	Smooth
Light Purple	Light Purple	Smooth



IAED 202 INTERIOR ARCHITECTURE AND ENVIRONMENTAL DESIGN STUDIO II

SCENARIO

The city Museum tries to meet the best into the present with their collection in the city Museum, we are going to design a multimedia library with that aim. In this multimedia library, there will be different types of collections such as books, periodicals, documents, music and video recordings, and other hard copy and digital data about the city. In the museum, cars which are from the past to the present are exhibited with different brands and companies. Besides the car collection, there are models, model cars and stories in there. The museum also not only pay attention to the cars, it also tries to reflect the features of the area of the various cars.

The multimedia library is generally concerned with area the cars. People can find lots of information about the car's design and manufacturing process, also about the companies and their designers. Also, people can find documentary material about cars and the life songs of those times.

I think to divide the space with massive floor. Under the massive floor, there are no walls inside just partitions. It is an open plan design in the ground floor. When people are there in this place, they have a view of all the ground floor. They see what's going on in that place.

Firstly, at the entrance, they see a seating place and a cafe area. In the store, there lots of items including models and models that people can buy. Also, they can make models in the seating area.

Secondly, when they walk along the way, they see the digital data area and resting area which are on different levels. In the resting area, they can watch some documentaries. Moreover, the digital data area is a place for people who want to watch or learn something individually. From the digital data area, there is an access to the simulation room. Also, on the ground level, there are displays of magazines, films and books.

On the mezzanine floor, this area is more like a library because there some shelves and displays for books, magazines and a video sound collection. When people go up to the mezzanine floor, they see the display, and behind the display area, there is a movie watching area but this area is about three steps from the display area. When they pass the bridge, there are some working places for people who want to take a break or something and study there.

I think this design concept needs to be associated with the whole museum. The library cannot be completely different from the museum.

INSPIRATION SOURCES

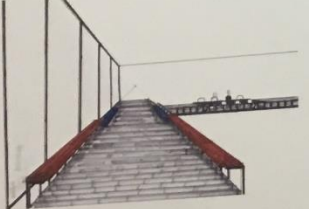

PERSPECTIVES



GROUND FLOOR PLAN

SCALE: 1/50

MEZZANINE FLOOR PLAN

SCALE: 1/50

GÜLPERİ ATAS - IAED 202

spaces for different activities. A multi-media library is a public building that provides a wide range of services for its users. It is a place where people can find information, learn, and enjoy themselves. The library is a place where people can find information, learn, and enjoy themselves. The library is a place where people can find information, learn, and enjoy themselves.



Types of Surface Coating



Types of Flooring

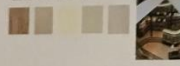

SECTION BB 1/50 SCALE



GROUND FLOOR PLAN 1/50 SCALE

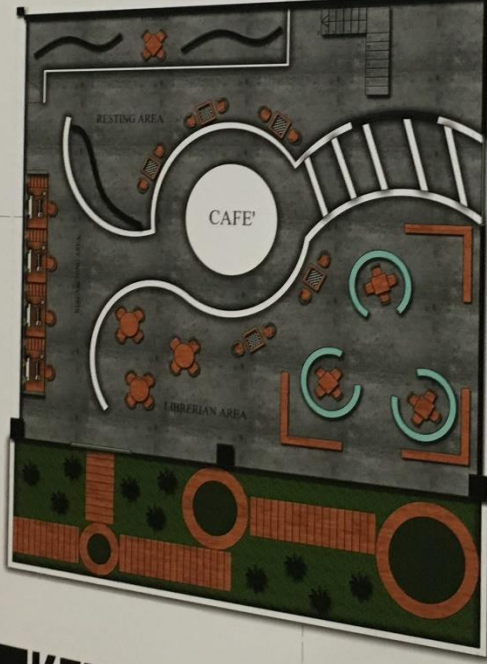

MEZZANINE FLOOR PLAN 1/50 SCALE



KEY MUSEUM









